

Temperature and humidity Sensor

**CT-EDZB4002-HM**

Temperature and humidity Sensor

Introduction

This product is an intelligent temperature humidity detector, Using the ultra-low power, ZigBee wireless network technology, the product stability is guaranteed from the design. The MCU microprocessors are also used for intelligent processing of temperature and humidity signals. Built-in high-precision temperature and humidity sensors can be used in real-time to feel the temperature humidity to the APP. The products are applicable to the environment monitoring in residential, workshop, machine room, shopping mall, hotel office, teaching building, bank, library and warehouse. Easy to install.

Technical Information

- Compatible with ZigBee network controller
- Battery powered and cost savings

- Sensitivity and small size

Specifications

- Radio protocol: ZigBee (IEEE 802.15.4)
- Operating voltage: DC3V(1×CR2450 Lithium Battery)
- Static current: $\leq 10\mu\text{A}$
- Networking way: ZigBee Network
- RF range: $\leq 70\text{m}$ (open area)
- Working Temperature: $-10^{\circ}\text{C}\sim+50^{\circ}\text{C}$
- Working humidity: $\leq 95\%\text{RH}$
- Dimension: $60\times 60\times 20.8\text{mm}$

Operation

As shown in figure 1, the temperature and humidity sensor has a reset button on the side, and its function is as following:

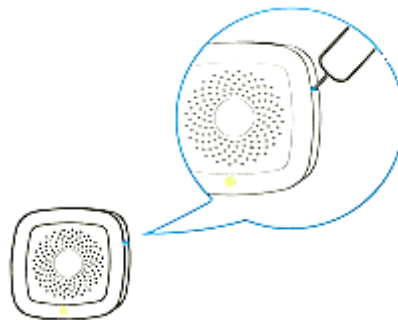

Fig.1

(1) If the temperature and humidity sensor has not been included into the network, short press the Reset button for 2 seconds to enter the network inclusion condition, at this time the network status indicator LED flash (3 times/second). If the network inclusion success, the network status indicator LED will long on for 2 seconds and then go out. If the network inclusion failure, the network status indicator LED will go out.

(2) If the temperature and humidity sensor has been included into the network, and want to include into the new network, you must reset the device. First, press and hold the Reset button until network status indicator LED flash once, and then long press the Reset button for 10 seconds, LED will long on for 3 seconds and then go out.

Note: Please loosen the button when the indicator LED long on 3 seconds, otherwise the system will restart and then into and network inclusion status.

ZIGBEE NETWORK INCLUSION

- 1) Connect the power supply
- 2) Press the Reset button for 2 seconds until see green LED blinking fast (Refer to the above steps).

Note: if you need to change the network, you need to check the reset button for 10 seconds

- 3) Choose "FBee" to enter the Network Inclusion mode on the APP, then click "  ".

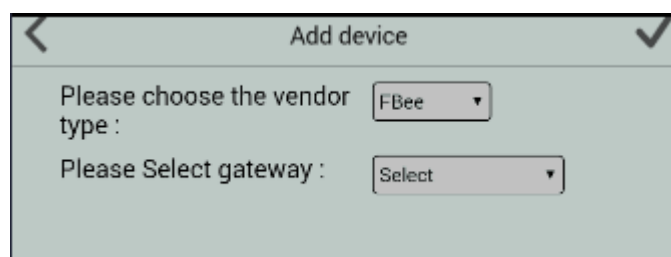

- 4) When prompt a message "Request Access Success", please go to the device list interface, and refresh the device list, the device will be displayed.

Installation Instructions

When the temperature and humidity probe is set up, it will enter the probe state. If user do the SMS alarm or email alarm configuration, such as when the trigger the alarm, mobile intelligent terminal will receive the alarm information, the user click the alarm information to go see the detailed information, let the user know and decide whether to take corresponding measures in a timely manner.

In order to ensure the detection effect, this product should be placed in the location of easy connection, not installed in the rain, oil smoke, dust environment. In addition, when installing this detector, you can simply install a 3V CR2450 lithium battery properly.

Installation Renderings

1. Remove the power insulation and make sure that the system properly powered

Factory default built in a CR2032 battery inside the detector and used a Mylar film to isolate batteries from electric circuit of the detector. Remove the battery Mylar film when ready to let the detector work.

If there is no battery inside the detector or need to replace a new battery, please insert the battery first.

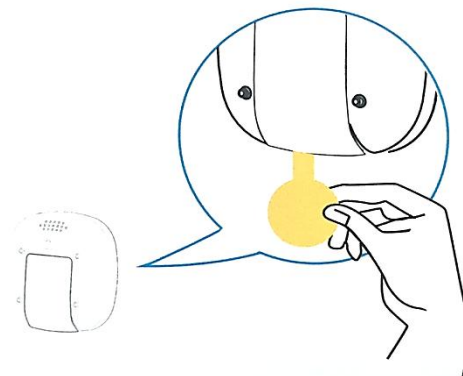

2. Make sure The equipment is connected to the ZigBee Gateway.

3. Tear down the double-sided adhesive film on the base of the mount and attach it to the appropriate area

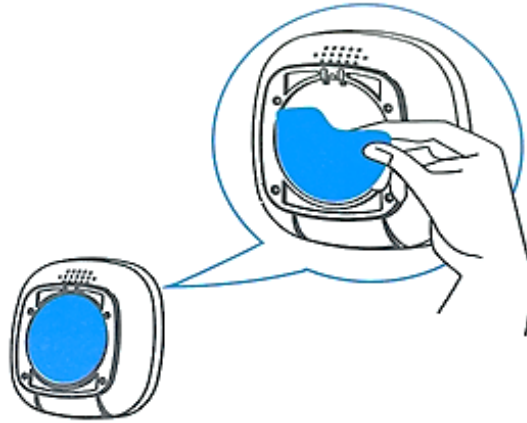

4. Note that the base of the installation must follow the arrows in the picture. The probe is then mounted to the mounting base.

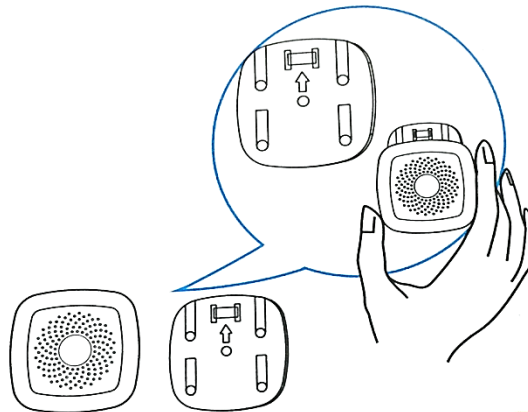

Safety Notice

- This device is a wireless communication product, please do not place the device to work in the metal container, in case the signal is blocked.
- The working temperature is -10°C to $+50^{\circ}\text{C}$.
- Keep the device away from a strong sunlight, humidity, high temperature or mechanical shock.
- Keep the device away from acid-base and other corrosive solids, liquids, gases, to avoid damage.