

# MOTION SENSOR



**CT-EDZW4006-FBR**  
Motion Sensor

## Introduction

The Motion Sensor is a universal Z-Wave multi-sensor. Along with detecting motion, the device measures the temperature and light intensity. The sensor has a built-in accelerometer to detect any tampering of the device. The Motion Sensor is a battery-powered device and designed to be installed quickly and easily on any surface. The LED indicator signals motion, temperature level, operating mode, and can be used to see if the device is within the Z-Wave network. The motion sensor can be used for lighting scenes and security monitoring systems.

## Technical Information

- Compatible with any Z-Wave network controller
- The Motion Sensor can detect motion with a built-in accelerometer
- Measure the temperature and light intensity

- Battery powered

## Specifications

- Radio protocol: Z-Wave 868.42MHz
- Power supply: DC 3V
- Battery type : CR123A
- Recommended installation height: 2.4m
- Operational Temperature: 0°C-40°C
- Measured Temperature: -20°C-100°C
- Temperature measuring accuracy: 0.5 °C(within 0 to 40 °C)
- Light measuring range: 0-32000 LUX
- Radio Frequency: 868.4MHz EU; 908.4MHz US; 921.4Hz ANZ; 869.2Hz RU
- Range : up to 50m outdoors, up to 30m indoors (depending on the building materials used)
- Dimension : 45mm (Diameter)

## Operation

As shown in figure 1, there is a B-Button on the surface of the Motion Sensor, which is used to carry out inclusion, exclusion or reset.

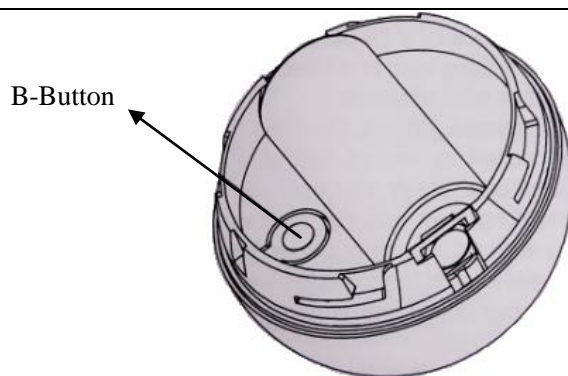
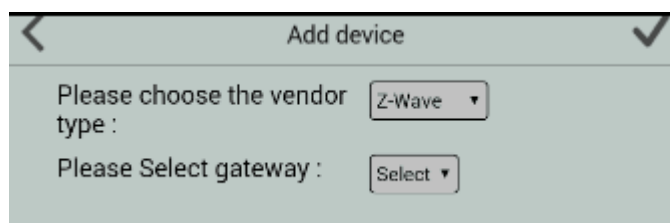

Fig.1

**Z-WAVE NETWORK INCLUSION**

- 1) Connect the power supply, and make sure that device in a state of "No node ID".
- 2) Choose "Z-Wave" to enter the Network Inclusion mode on the APP, then click "✓".



- 3) Triple click the B-Button in 1.5 seconds (LED diode will grow blue).
- 4) When prompt a message "Request Access Success", please go to the device list interface, and refresh the device list, the device will be displayed.

**Z-WAVE NETWORK EXCLUSION**

- 1) Make sure the device is connected to the power supply.
- 2) Remove the device on the APP, then click "finish".
- 3) Triple click the B-Button in 1.5 seconds (LED diode will grow blue).
- 4) Please go to the device list interface, and refresh the device list, the device will not be displayed.
- 5) If the device can still be displayed (network exclusion failed), repeat steps 2-4.

**NOTE:**

If the device is online, directly perform steps 1-5, if the device is offline, need interruption of the device power supply first, and then perform step 1-5.

**ROLLER SHUTTER RESET**

Reset procedure clears the modules' EPROM memory, including all information about the Z-Wave network controller, calibration and power consumption data.

- 1) Make sure the device is connected to the power supply.
- 2) Press and hold the B-Button for 4-6seconds.
- 3) Release the B-Button.
- 4) Press the B-Button briefly, once.

**Successful reset will not be confirmed with the LED changing color to red and then turning off.**

## Installation Instructions

It's recommended to install the sensor on the wall or place it in the right place directly.

### **MOTION SENSOR INSTALLATION**

1. Screw down the device on the clockwise direction, and remove the battery Mylar film when ready to let the detector work, so that the device is energized, and then put on the cover with a counter clockwise direction.
2. Install the holder as shown in Figure 2.

The specific installation position can be determined according to the actual detection angle and range of the device. After the decision, use the holder as a reference, to mark the position of the lock screw. Using the drill to drill a screw hole in the wall or other suitable position, then push the enclosed plastic gecko into the hole, lastly fix the holder.

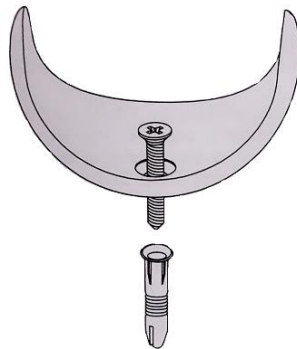

Fig.2

3. Insert sensor to the holder and make it fixed.
4. After the installation is completed and the test is no problem, then the sensor will enter the normal operation mode.

### Safety Notice

- Don't make the device directly to the window/fan/air-conditioner or sunlight.
- Do not install the device above or facing any source of heat directly, such as fires, radiators, boilers, etc.
- Confirm the device is positioned in place where the light source detected by the detector is consistent with actual ambient illumination. Do not locate the detector in shadowy place.
- Where possible, mount the detector so that the logical path of an intruder would cut across the fan pattern rather than directly towards the detector.
- In order to obtain the best results, please put the detector directly facing the entrance.